

33-1.45 W07 S

Pneumatic direct change

Item no. **10300007**

HF-Spindle for high-speed milling, -grinding, -drilling, -engraving

Bearings

Steel ball bearing (pcs)	2
Lifetime lubricated	maintenance free

Motor

Motor technology	3-phase asynchronous drive (no brushes or sensors)
Frequency	1.000 Hz
Motor poles (pairs)	1
Rated rotation speed	60.000 rpm

Power values

Uncooled

	Pmax / 5 s	S6-60%	S1-100%	
Rated power	0,24	0,24	0,18	[kW]
Voltage	46	46	44	[V]
Current	6,5	6,5	5,5	[A]

33-1.45 W07 S

Pneumatic direct change
Item no. **10300007**

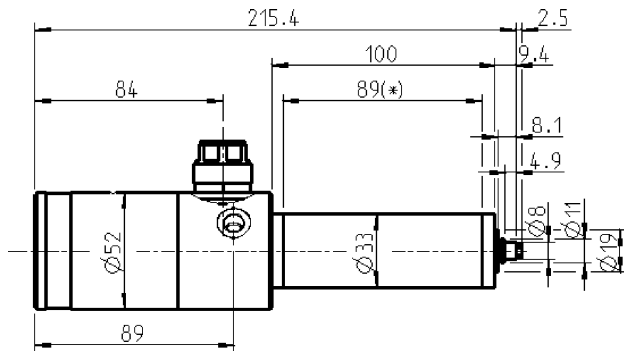

Dimensions

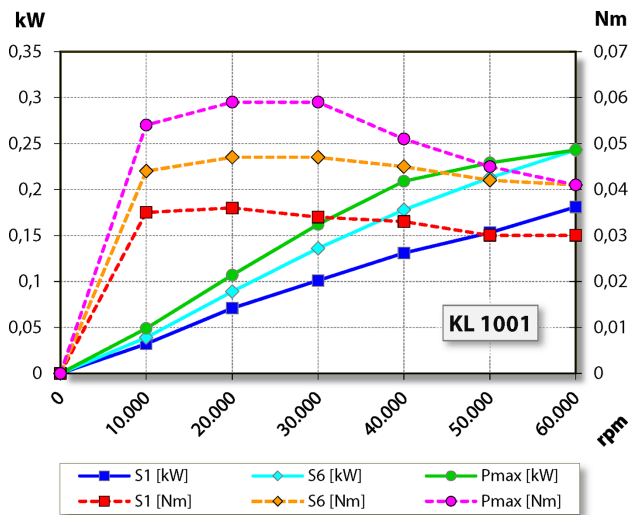

Performance Diagram

Uncooled

Measurement of power is funded by in-house testing.

Characteristics

Motor protection	PTC 100°C
Housing	Aluminium
Housing diameter	33 mm
Cooling	Uncooled
Heat dissipation	Via the spindle holder
Housing temperature	< + 45° C
Ambient temperature	+ 10°C ... + 45°C
Sealing air	
Protection category (sealing air turned on)	IP54
ESD protection	
Tool change	Pneumatic direct change
Collet type	5,1P-5°
Clamping range up to	3.5 mm (1/8")
Clockwise	
Coupler plug	7-pin plastic
Weight	~ 1,1 kg
Inner taper run out	< 1 μ